



Product manual

Butterfly fire damper cartridge

BFDC, BFDC-V

Fire dampers

Version 1.0.0
Date: 19.03.2024.

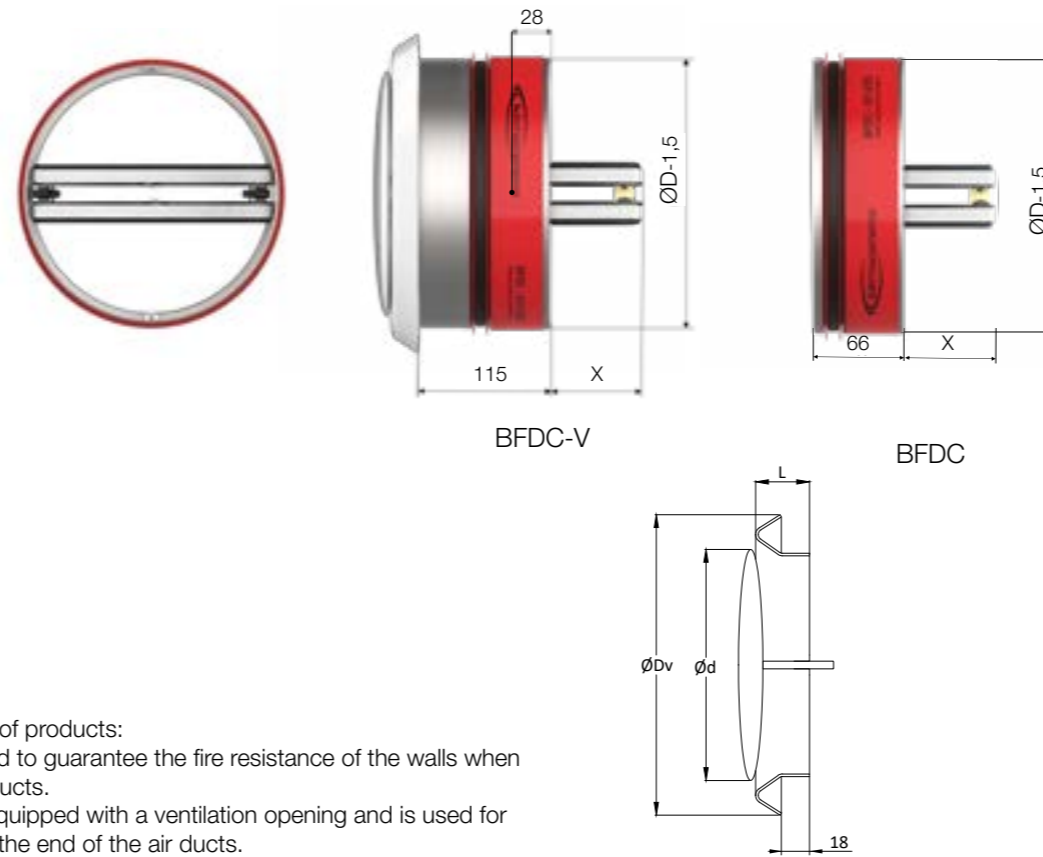

BFDC / BFDC-V Butterfly fire damper cartridge

The circular end valves are installed in circular ventilation ducts at the wall passages, for stop the spread of fire. They have fire resistance up to 120 minutes.

We have 2 types of products:

- BFDC is used to guarantee the fire resistance of the walls when passing air ducts.
- BFDC-V is equipped with a ventilation opening and is used for mounting at the end of the air ducts.
- The products are equipped with a thermal fuse.

- ▶ Product overview
- ▶ Installations
- ▶ Ordering keys
- ▶ Maintenance



PRODUCT OVERVIEW

BUTTERFLY FIRE DAMPER

DIMENSIONS

ØD (mm)	BFDC / BFDC-V X
100	18
125	30,5
160	48
200	68

ØD (mm)	100	125	160	200
ØDv	150	185	220	260
Ød	89	115	145	182
L	47	49	51	53

BFDC



BFDC-V



1. Steel casing
2. Damper blades
3. Intumescent joints around the casing
4. Rubber seals
5. Thermal fuse 72 ° C
6. 2 safety clips
7. Regulation disc
8. Product marking

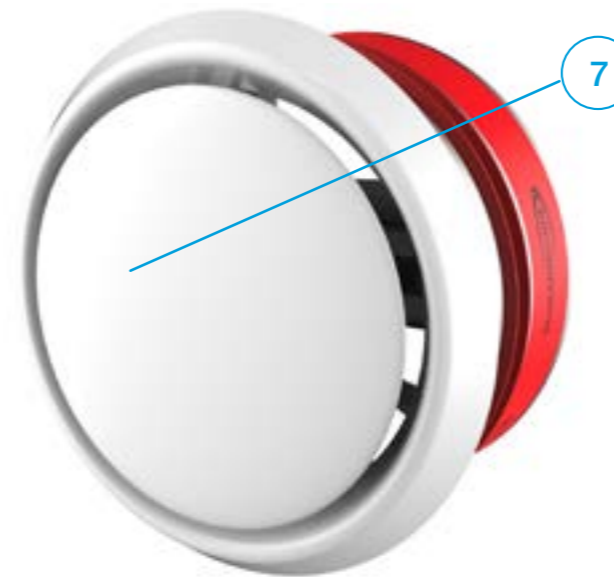
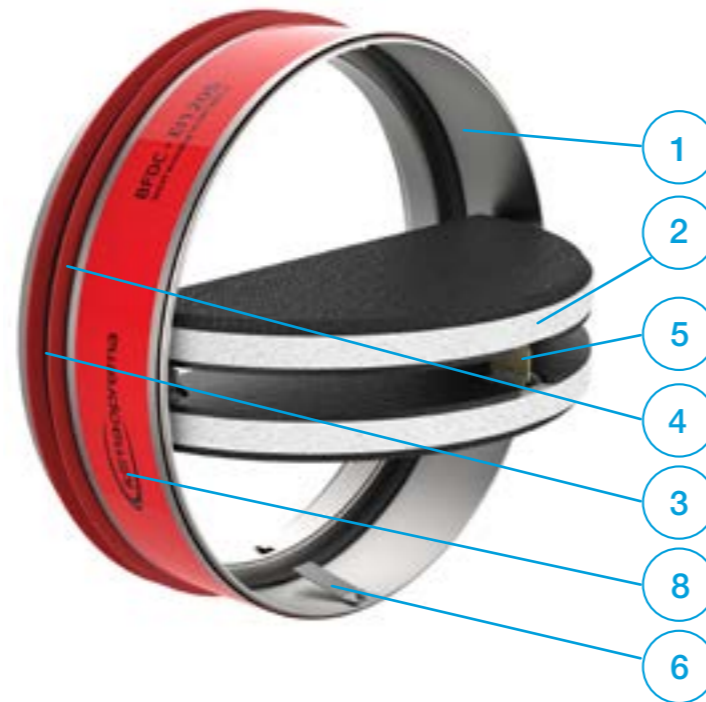

- ▼ Product overview
- ▼ Installations
- ▼ Ordering keys
- ▼ Maintenance



Certifications and test reports

All our end valves are subjected to several tests by official institutions. The reports of these tests form the basis of the certifications of our products



Installation

- Mounting is possible with the axis in horizontal or vertical position.
- The installation must conform to the test report.
- The direction of air circulation is indifferent.
- The product must be accessible for inspection and maintenance.

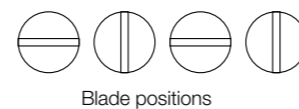







The terminal valve is always tested in standardized support frames (both in a massive wall, slab massive than in a flexible wall) in accordance with EN 1366-2: 1999 table 3/4/5 of support frames standardized. The results obtained are valid for all frames of similar supports that have a fire resistance and / or a thickness and / or density similar or greater than that of the test.

Examples of similar constructions

Reinforced concrete wall min. 100 mm + density 2,200 kg / m ³ + fire resistance ≥ 120 ‘	Masonry wall made of hollow or solid bricks, concrete, concrete cellular, light concrete ...
Reinforced concrete slab thickness 100 mm + density 2,200 kg / m ³ + fire resistance 120 ‘	Concrete parts, prestressed concrete ...
Flexible wall: metal stud + drywall fire resistance: 100 mm + fire resistance ≥ 90 ‘	Metal stud + GKF plates, multiple levels of plaster

TECHNICAL DATA

Control mechanism	BFDC	BFDC-V
Type of product	Cartouche coupe-feu	Cartouche coupe-feu papillon avec vanne d'air
Family	Section circulaire	Section circulaire
Certificate		
Obligation	Resettable by direct action on the movable element after manual extraction of the flap valve	
Prohibition	À énergie intrinsèque	À énergie intrinsèque
Command mode	Autocommandé par déclencheur thermique taré à 72 °C	
Mounting direction	Horizontal ou vertical	Horizontal ou vertical
Direction of air circulation	Indifférent	
Free surface	BFDC 60/90/120 $\varnothing 100 - 125 : SL (dm^2) = [\pi/4 (\varnothing D - 15,2)^2 - 33(\varnothing D - 15,2) - 97,5] / 10\ 000$ $\varnothing 160 - 200 : SL (dm^2) = [\pi/4 (\varnothing D - 15,2)^2 - 33(\varnothing D - 15,2) - 220] / 10\ 000$	
Dimensions L x H	$\varnothing 100$ mm to 200 mm	$\varnothing 100$ mm to 200 mm
Endurance	Après 50 cycles les caractéristiques sont restées dans les valeurs limites déclarées	
Degrees of resistance	Fire resistance according to EN 13501-3: - BFDC-120 / BFDC-V-120 : EI120(ve, ho i→o)S : $\varnothing 100 - \varnothing 200$: - BFDC-90 / BFDC-V-90 : EI90(ve, ho i→o)S : $\varnothing 100 - \varnothing 200$: - BFDC-60 / BFDC-V-60 : EI60(ve, ho i→o)S : $\varnothing 100 - \varnothing 200$:	Montage en paroi massive 100 mm ≥ 120 ' Montage en dalle massive 100 mm ≥ 120 ' Montage en paroi flexible 100 mm ≥ 90 ' Montage en paroi flexible 100 mm ≥ 60 ' Montage en paroi massive 100 mm ≥ 120 ' Montage en dalle massive 100 mm ≥ 120 ' Montage en paroi flexible 100 mm ≥ 90 ' Montage en paroi flexible 100 mm ≥ 60 ' Montage en paroi massive 100 mm ≥ 120 ' Montage en dalle massive 100 mm ≥ 120 ' Montage en paroi flexible 100 mm ≥ 90 ' Montage en paroi flexible 100 mm ≥ 60 '
Mounting type	Recessed wall or floor according to the configuration	
Fire side	Side opposite the thermal fuse	Side opposite the thermal fuse
Security position	Closed	Closed
Position indication	No	No
Temperature of use	Max. 50 ° C	Max. 50 ° C
Environment	For indoor use	For indoor use
Relative humidity	< 95%, non condensating	
Degree of protection	IP 65	IP 65
Interview	Maintenance free	Maintenance free
Modular product	Yes	Yes
List of service kits	See page 11	See page 11

-  Product overview
-  Installations
-  Ordering keys
-  Maintenance



PRODUCT OVERVIEW

Wall mounting / solid slab or ceiling in

The terminal valve was tested in a 100 mm reinforced concrete wall, a 100 mm cellular concrete wall (120' fire resistance) and a 100 mm reinforced concrete slab (120' fire resistance).

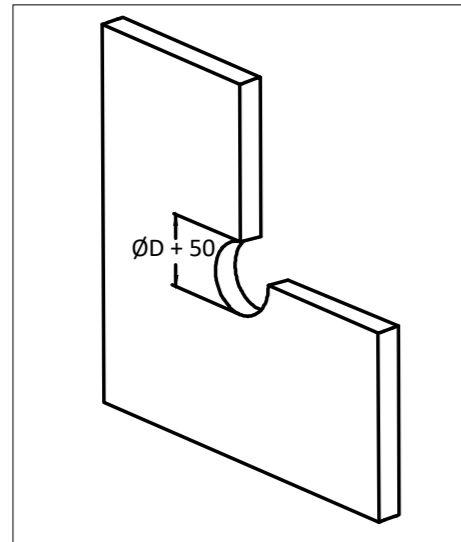

1. Provide an opening in the wall / slab / ceiling of at least = $\varnothing D + 50$ mm.

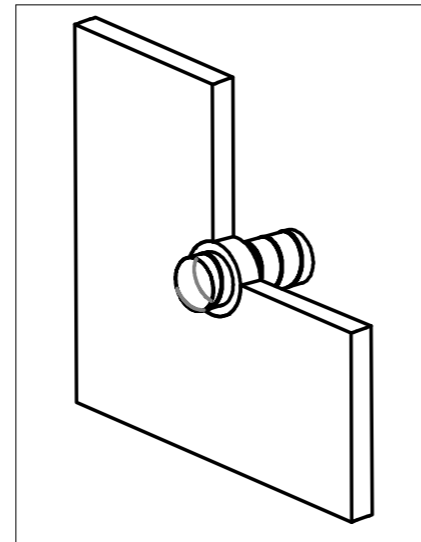

2. Place a metal conduit in the opening. The clearance between the duct and the wall / slab / ceiling must be filled completely with mortar.

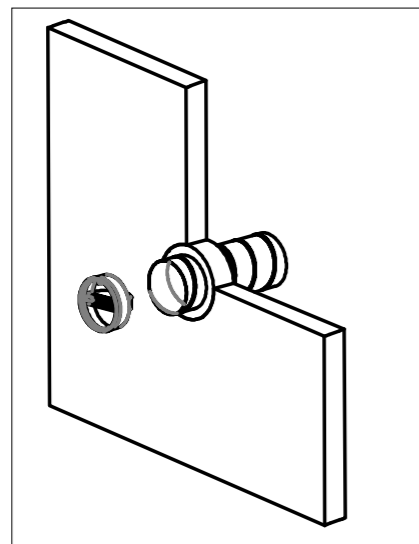

3. Insert the damper into the duct at a depth of 20mm from the wall surface so that the blade is oriented in the direction of the sheath.

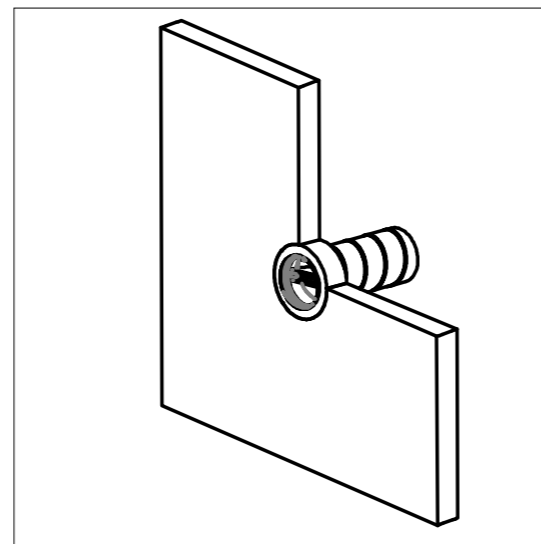

- ▼ Product overview
- ▼ Installations
- ▼ Ordering keys
- ▼ Maintenance

INSTALLATION

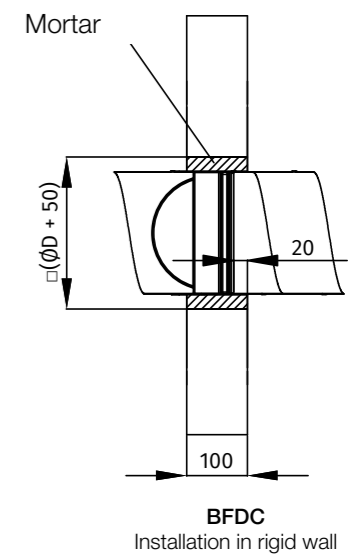
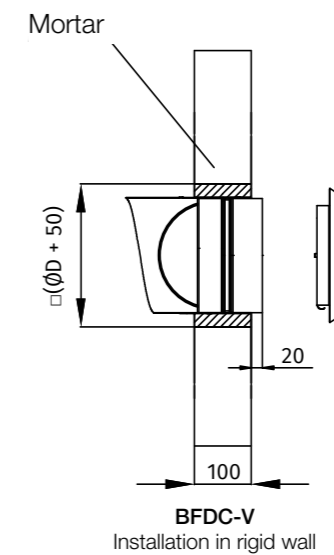

Flexible wall mounting - plasterboard wall

The fire damper cartridge has been tested in a metal wall stud plasterboard (fire resistance 60') with a thickness of at least 100 mm. The fire resistance of the wall must be similar or greater than that of the terminal valve.

A plasterboard wall is composed of:

- A metal frame consisting of metal horizontal and vertical studs (minimum width 50 mm).
- Rock wool with a thickness of 40 mm and a density of at least 100 kg / m³ between the coating.
- Double coating: two GKB plasterboards on both sides (fire resistance 60 ').

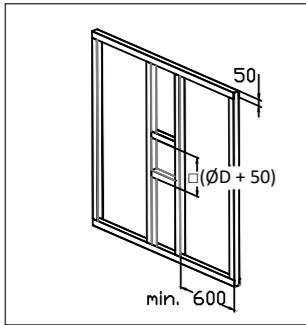

1. Provide an opening of at least = $(\text{ØD} + 50)$ mm x $(\text{ØD} + 50)$ mm + horizontal studs in the wall.

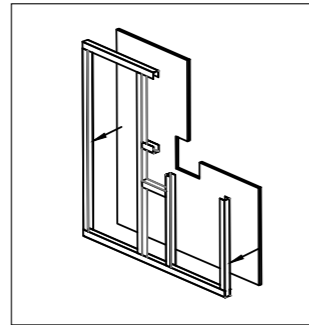

2. Attach two GKB plasterboards 12.5 mm thick to one side of the stud wall. For a metal stud wall with 60 'fire resistance, use fire-resistant plasterboard of the same thickness.

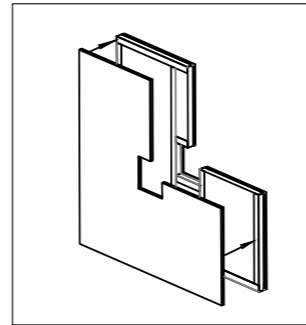

3. Insulate the wall entirely with rockwool (40 mm - 100 kg / m³) and finish with two GKB plaster plates.

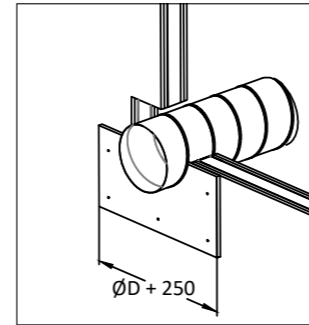

4. Insert the ventilation duct into a hole in the wall and press it on the GKB plate of width $(\text{ØD} + 250\text{mm})$ and with the central hole $(\text{ØD} + 5\text{mm})$, then tighten with self-tightening screws, tapping machines 5,5x70 mm.

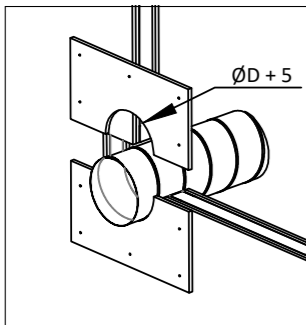

5. Cover with another GKB plate of the same dimensions and tighten with self-tapping screws 5.5x70 mm.

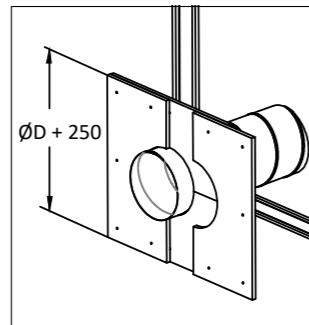

6. Install another layer of GKB plates perpendicular to the first layer and tighten with 5.5x70 mm self-tapping screws.

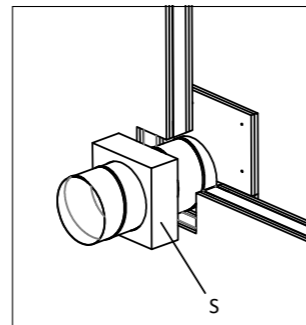

7. Completely fill the S connection between the duct and the wall with rock wool (density of at least 100 kg / m³)

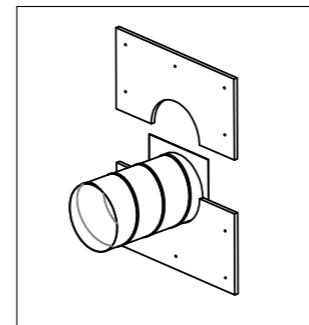

8. Complete the filling with a layer of GKB plates and tighten them with the 5.5x70 mm screws.

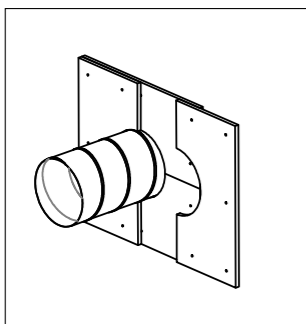

9. Install another layer of GKB plates perpendicular to the previous one and tighten with self-tapping screws 5.5x70 mm

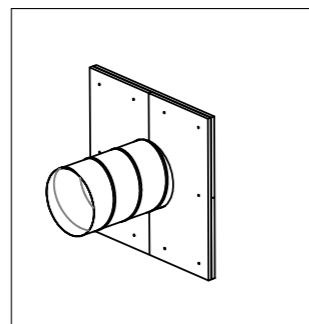

10. Place the fire damper cartridge in the conduit so that the face of the cartridge is 45 mm from the surface of the wall. A BFDC must be mounted so that the mouth is positioned against the wall

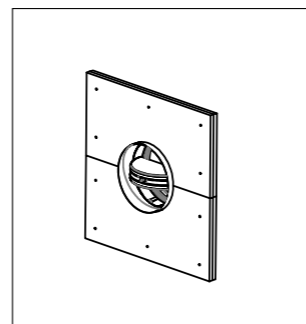

- ▼ Product overview
- ▼ Installations
- ▼ Ordering keys
- ▼ Maintenance

INSTALLATION

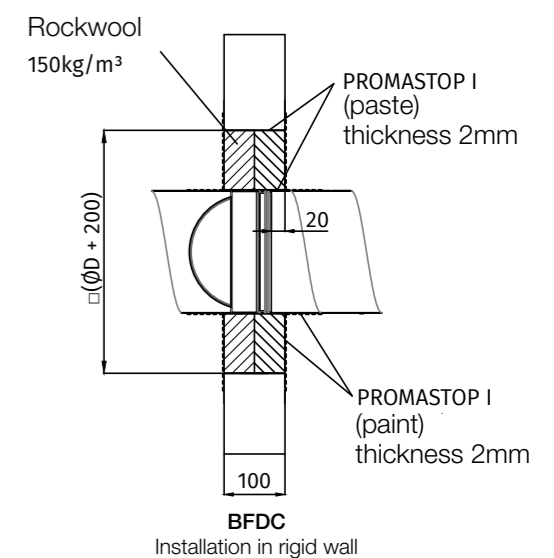
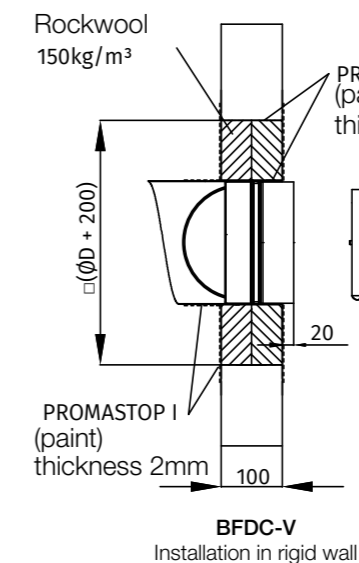

Flexible wall mounting - plasterboard wall

The fire damper cartridge has been tested in a metal wall stud plasterboard (fire resistance 90') with a thickness of at least 100 mm. The fire resistance of the wall must be similar or greater than that of the terminal valve.

A wall of plasterboard is composed of:

- A metal frame consisting of metal horizontal and vertical studs (minimum width 50 mm).
- The space between the duct and the wall is filled with plaster of gypsum
- Double coating: two GKF drywall on both sides (90' fire resistance).

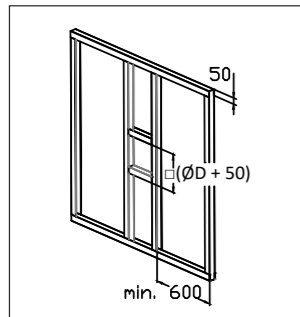

1. Provide an opening of at least = $(\text{ØD} + 50)$ mm x $(\text{ØD} + 50)$ mm + horizontal consolidations in the wall.

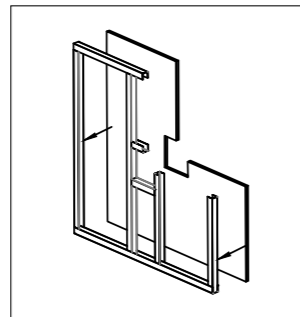

2. Attach two GKF plasterboards 12.5 mm thick to one side of the stud wall. For a metal stud wall with 90' fire resistance, use fire-resistant plasterboard of the same thickness.

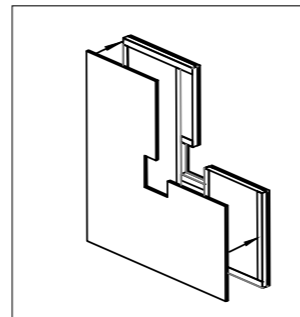

3. Insulate the wall entirely with rockwool (40 mm - 100 kg / m³) and finish with two GKF plaster lacquers.

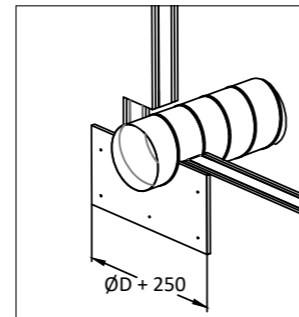

4. Insert the ventilation duct into a hole in the wall and press it on the GKF plate of width $(\text{ØD} + 250)$ mm and with the central hole $(\text{ØD} + 5)$ mm, then tighten with self-tightening screws, tapping machines 5,5x70 mm.

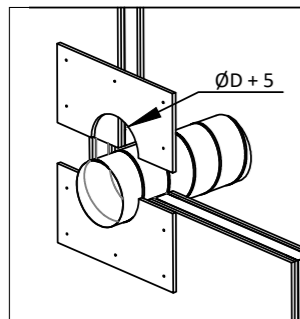

5. Cover with another GKF plate of the same dimensions and tighten with self-tapping 5.5x70 mm screws.

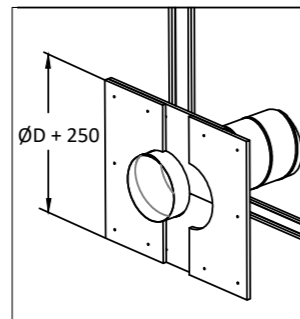

6. Install another layer of GKF plates perpendicular to the first layer and tighten with self-tapping 5.5x70 mm screws.

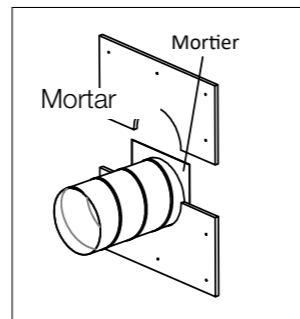

7. Fill the gap between the wall and the valve with plaster, cover it with the GKF plate and tighten it with screws.

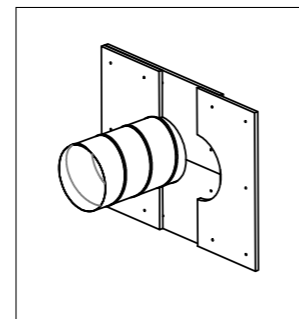

8. Install another layer of GKF plates perpendicular to the previous one and tighten with screws.

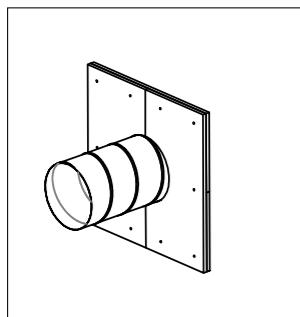

9. Insert the BFDC valve into the duct at a depth of 20 mm from the wall surface so that the blade is oriented in the direction of the duct.

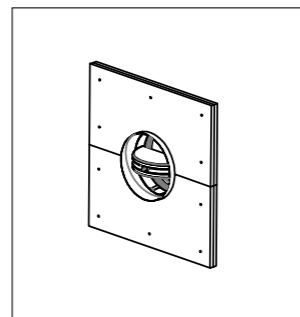

- ▼ Product overview
- ▼ Installations
- ▼ Ordering keys
- ▼ Maintenance

INSTALLATION

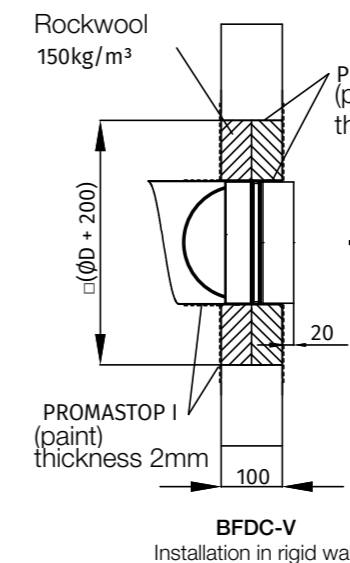

BFDC-V
Installation in rigid wall

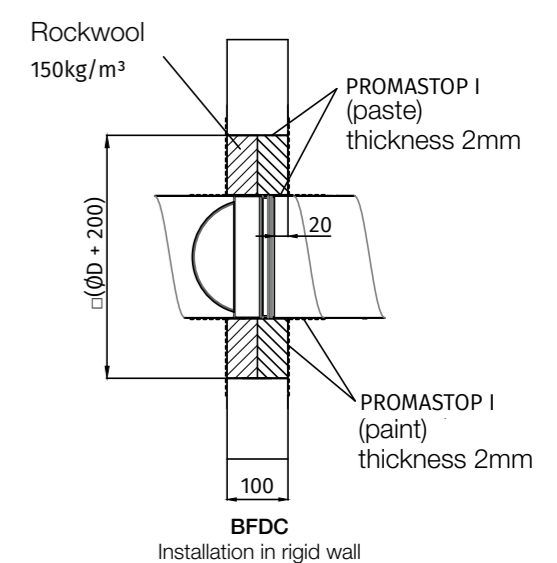

BFDC
Installation in rigid wall

Flexible wall mounting - plasterboard wall

The fire damper cartridge has been tested in a metal wall stud plasterboard (fire resistance 90') with a thickness of at least 100 mm. The fire resistance of the wall must be similar or greater than that of the terminal valve.

A wall of plasterboard is composed of:

- A metal frame composed of metal horizontal and vertical studs (minimum width 50 mm).
- Rock wool with a thickness of 40 mm and a density of at least 100 kg / m³ between the coating.
- Double coating: two GKF drywall on both sides (90' fire resistance).

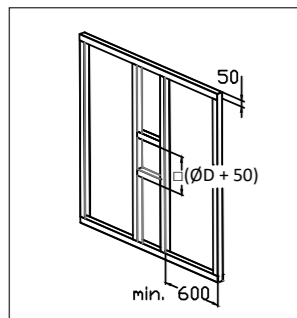

1. Provide an opening of at least = $(\text{ØD} + 50)$ mm x $(\text{ØD} + 50)$ mm + horizontal consolidations in the wall.

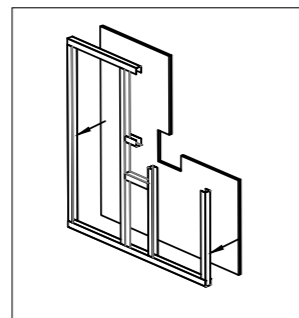

2. Attach two GKF plasterboards 12.5 mm thick to one side of the stud wall. For a metal stud wall with 90' fire resistance, use fire-resistant plasterboard of the same thickness.

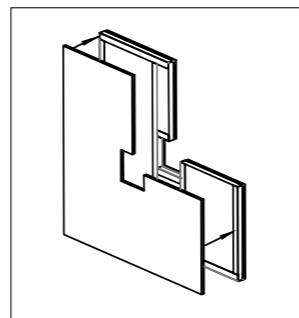

3. Insulate the wall entirely with rockwool (40 mm - 100 kg / m³) and finish with two GKF plaster lacquers.

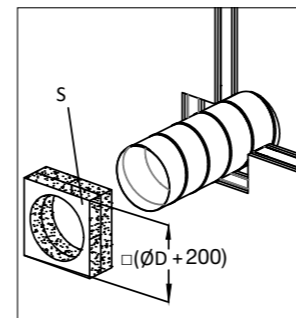

4. Insert the ventilation duct into a hole in the wall and fill the gap between the duct and the wall with two layers of mineral wool 100 kg / m³ density, 50 mm thick and $(\text{ØD} + 200)$ mm width. The outer and inner edges as well as the tactile surfaces between the layers of wool should be previously primed fireproof coating.

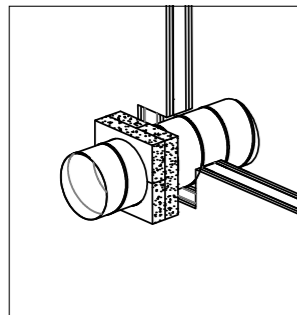

5. Coat the wool filler, the sheath portion and the wall contact points and fill the rock wool with a fire-resistant coating in the thickness of 2 mm.

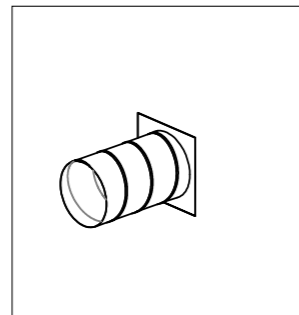

6. Insert the BFDC valve into the duct at a depth of 20 mm from the wall surface so that the blade is facing in the direction of the duct.

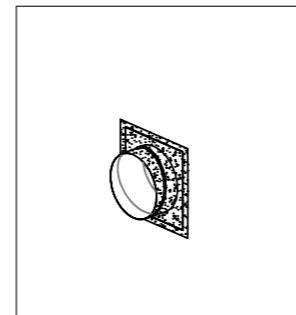
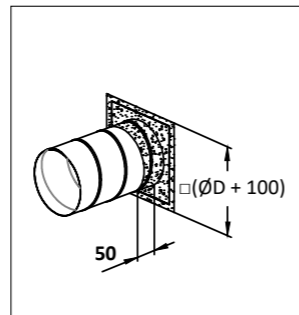

- ▼ Product overview
- ▼ Installations
- ▼ Ordering keys
- ▼ Maintenance



INSTALLATION

Other possible installations

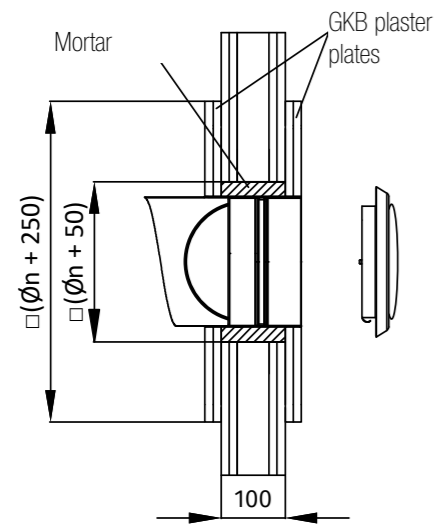

BFDC-V
Installation in flexible wall

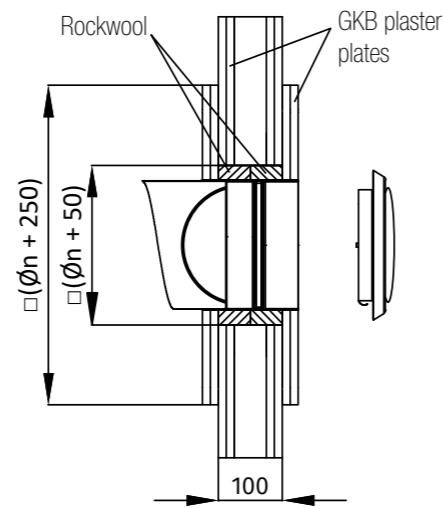

BFDC-V
Installation in flexible wall

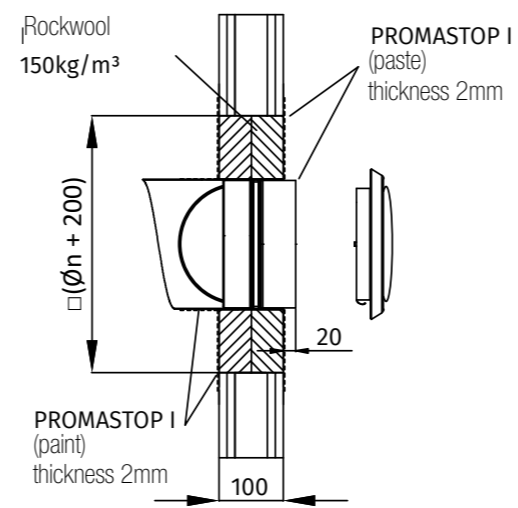

BFDC-V
Installation in flexible wall

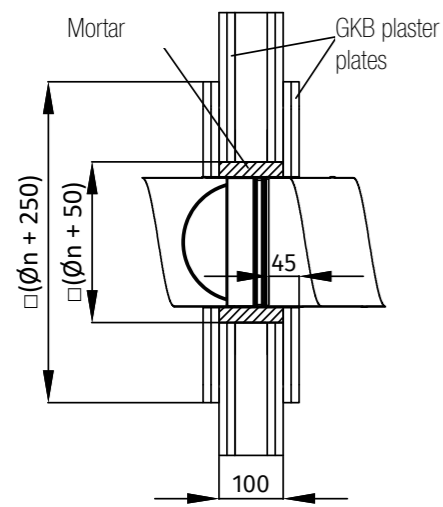

BFDC
Installation in flexible wall

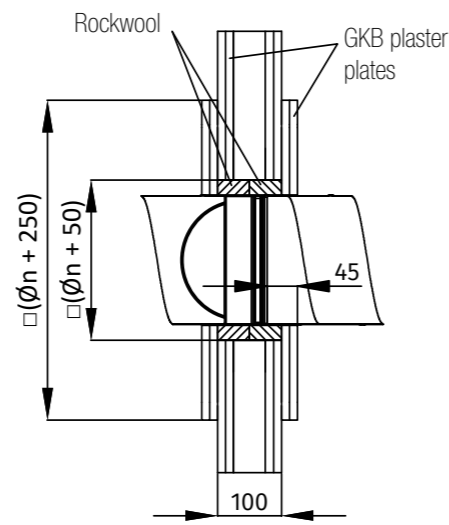

BFDC
Installation in flexible wall

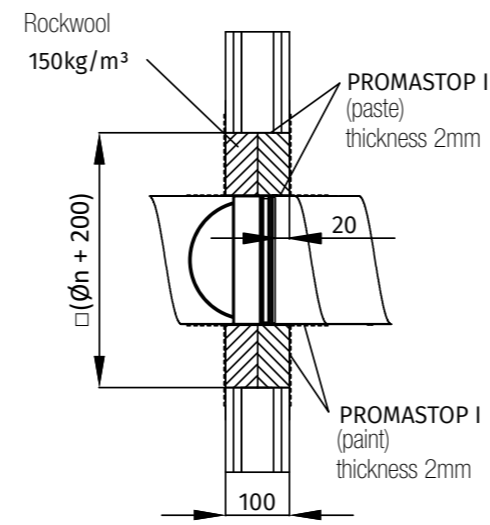

BFDC
Installation in flexible wall

- ▼ Product overview
- ▼ Installations
- ▼ Ordering keys
- ▼ Maintenance



INSTALLATION

Minimal distance between BFDC and wall, ceiling and other fire dampers

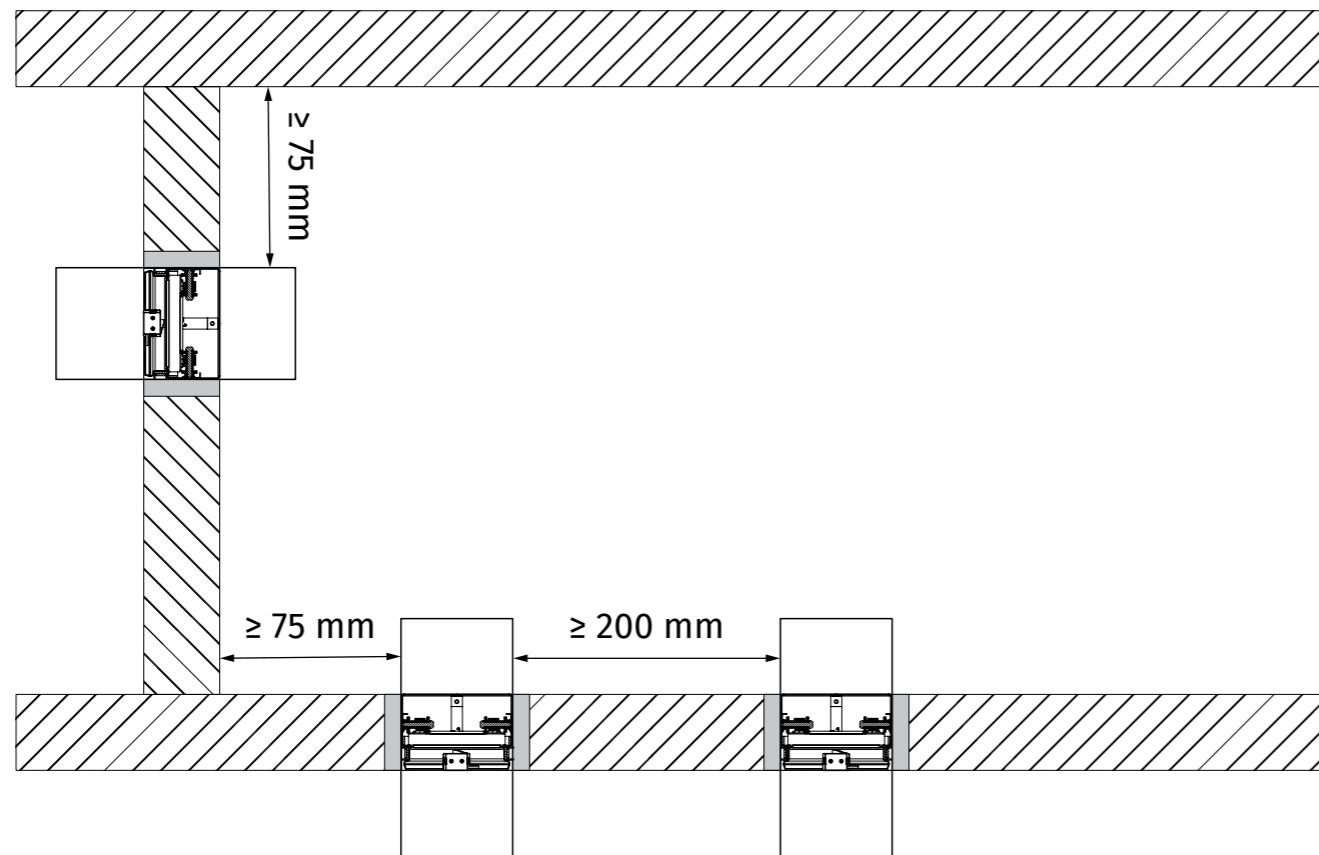

- ▼ Product overview
- ▼ Installations
- ▼ Ordering keys
- ▼ Maintenance

 INSTALLATION

OPERATION

The circular fire damper cartridge is held in the open position by the fuse. As soon as the temperature in the sheath exceeds 72 ° C, the thermal fuse trips and both blades close. The terminal valve is then in the closed position.

Two stop tabs lock the blades in this position, ensuring a perfect seal against flames and smoke.



1. Push the two stop tabs to unlock the blades.



2. Push the blades toward each other.

3. Snap the fuse into the bracket to lock the blades.

4. Trigger the blades by pushing them towards each other and exerting light pressure on the fuse.

- ▼ Product overview
- ▼ Installations
- ▼ Ordering keys
- ▼ Maintenance

SERVICE KITS

	Fusible 5026	BFDC-		Kit FCU	BFDC-5025
	Thermal fuse (5 pieces)			Unipolar limit switch contact	

Explanation of abbreviations (on page 10)

E = integrity o → i = fire side = side opposite the fuse
 I = thermal insulation ve = wall mounting in duct
 S = smoke leakage ho = slab / ceiling mounting

FCU kit installation

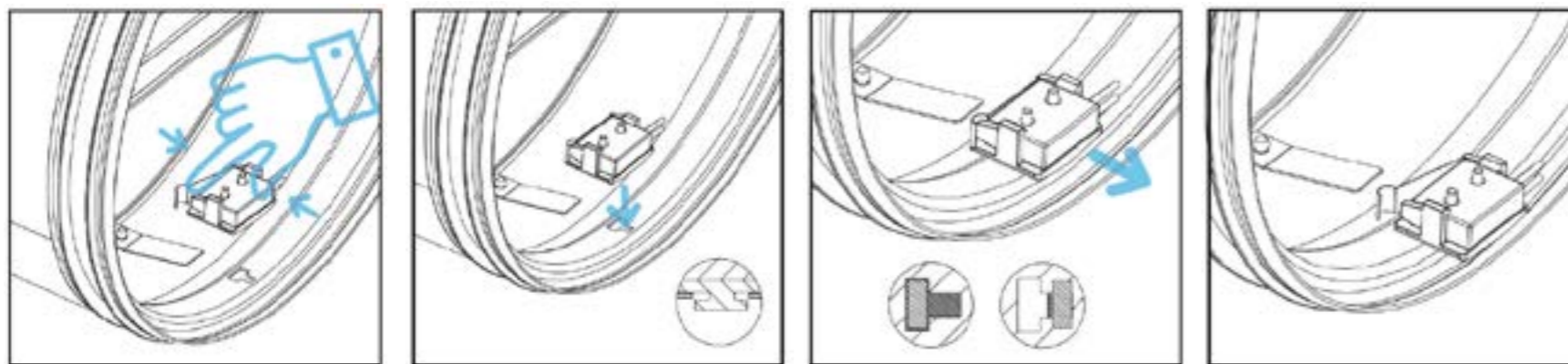

- Product overview
- Installations
- Ordering keys
- Maintenance



ORDERING KEY

ORDERING KEY

(1) Fire damper	(2) Certificate	(3) Dimension
BFDC	-	EI120S
(1) BFDC BFDC-V		(3) Dimension ød: -100 mm -125 mm -160 mm -200 mm
(2) Certificate EI60S EI 60 S (ve, i-o) EI90S EI 90 S (ve, i-o) EI120S EI 120 S (ho, i-o)		



- ▼ Product overview
- ▼ Installations
- ▼ Ordering keys
- ▼ Maintenance



STORAGE AND HANDLING

As a security feature, the terminal valve must be stored and handled with care.

Warning :

- Avoid any deterioration.
- Avoid contact with water.
- Avoid casing deformation during assembly and operation.
- Unload in a dry area.
- Avoid shocks..

MAINTENANCE AND SERVICE

- No special maintenance.
- Cleaning the assembly (dust) at start-up.
- Attention, the BFDC and BFDC-V, in closed position, can move in the sheath in case of pressure too strong.



FIRE PROTECTION

Projektiranje, proizvodnja i održavanje opreme za klimatizaciju, ventilaciju i čiste prostore.
Design, production and service of Ventilation, Air-Conditioning and Cleanroom equipment.

- 📍 Gradna 78A, 10430 Samobor, Croatia
- ☎ +385 (0)1 33 62 513
- ✉ info@klimaoprema.com
- 🌐 www.klimaoprema.com